



Cladding Board Specifications:

Size: 156mm x 21mm x 5400mm

Visible Width: 135mm

Colour: Dark Grey – Ivory - Coffee

Max Span: 600mm

Weight: 10.2kg per length

1. Measure and mark a line 20mm away from your wall/structure (this distance is important to allow for expansion from the house due to weather changes and accommodate the overlap of cladding boards)
2. Screw in the Starter Clips 20mm from the wall/structure.
3. Lay the first board onto the frame – fitting it firmly into the starter clips, use a rubber mallet if necessary.
4. Using a 4mm drill bit, pre-drill a hole through the cladding board into the timber underneath, take care not to drill too far into the timber
5. Add screws to the drilled holes to secure cladding board to timber – be sure to screw in just enough to keep cladding in place to avoid cracking the cladding
6. Fit the next board onto first board, using a rubber mallet if necessary
7. Repeat steps 4-6 until cladding is complete

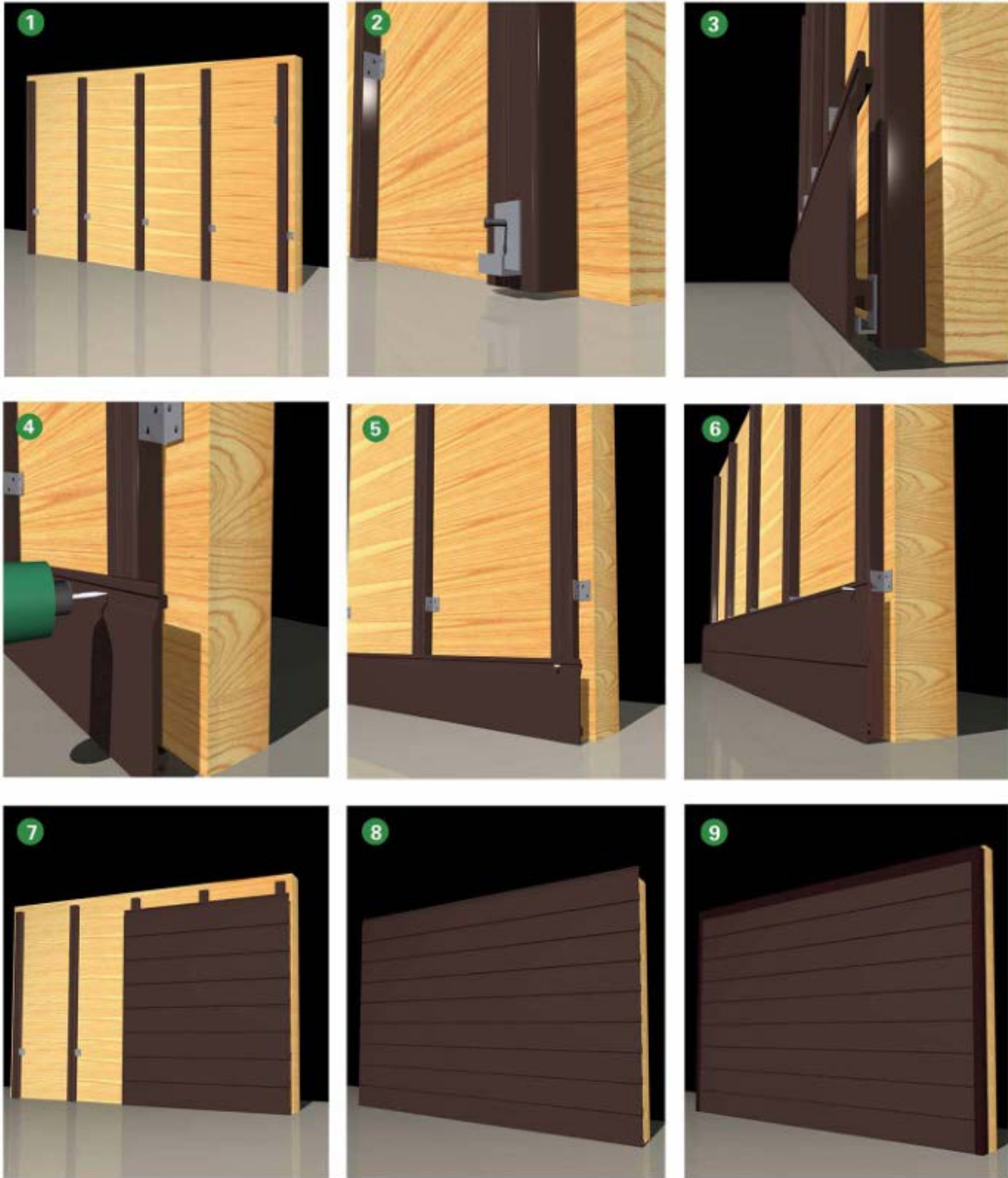

TUFRIGHT PTY LTD

31A PRODUCTION DRIVE CAMPBELLFIELD VIC 3061

PHONE : 03 9357 7525

EMAIL: INFO@TUFRIGHT.COM.AU

WEB: WWW.TUFRIGHT.COM.AU